



**Architecture for All**

**An Inclusive Approach to the Design of  
Built Environments**

**Fionnuala Rogerson FRIAI  
Director, UIA Architecture for All Work Programme**

**Milan, Italy  
25<sup>th</sup> May 2015**

**INTERNATIONAL UNION OF ARCHITECTS**

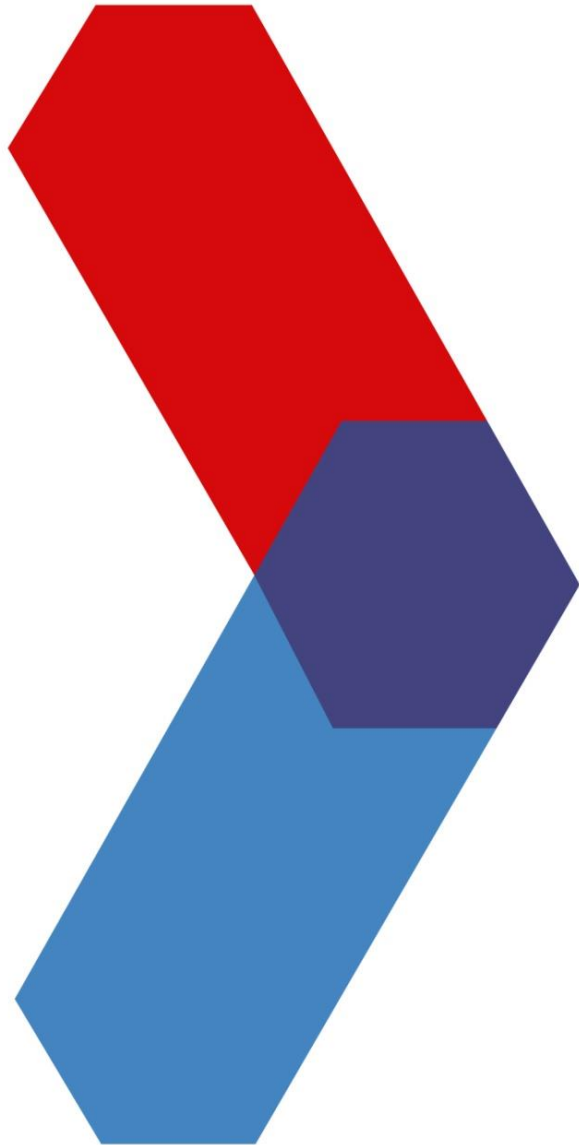

# **Good Practice from around Europe and further afield**

# UIA Award

## Friendly Spaces Accessible to All



- Promotes high quality architectural design of buildings & public spaces
- Contributes to global quality of life and well being.

# Criteria



Hazelwood School  
Murray & Dunlop Architects  
Photo: Andrew Lee

Projects must be:

- Accessible
- Safe
- Inviting
- Inspiring
- Comfortable
- Attractive

# Demonstrating an inclusive approach



- Scale
- Form
- Colour
- Light
- Context
- Detail



# Poland

## Malopolska Garden of Arts

**2014 WINNER  
Public Building**

**A new arts centre,  
open and  
welcoming.**

**A meeting place for  
artists and lovers of  
art regardless of  
age, views or  
nationalities**



Ingarden & Ewy Architects

INTERNATIONAL UNION OF ARCHITECTS

# Poland

## Malopolska Garden of Arts



**Visitors of all ages are encouraged to integrate, participate, discover and debate culture**



**INTERNATIONAL UNION OF ARCHITECTS**



**Greece**

# New Waterfront Thessaloniki



**2014 WINNER**

**Public Open Space**

**Redevelopment of the seafront at Thessaloniki with a long promenade linking a series of themed accessible and sensory gardens**



Nikiforidis - Cuomo Architects

**INTERNATIONAL UNION OF ARCHITECTS**



# Greece

## New Waterfront Thessaloniki



**The promenade has a guidance path and lighting designed to facilitate people with vision impairments  
Signage, cycle paths & children's playgrounds are all carefully considered & integrated**

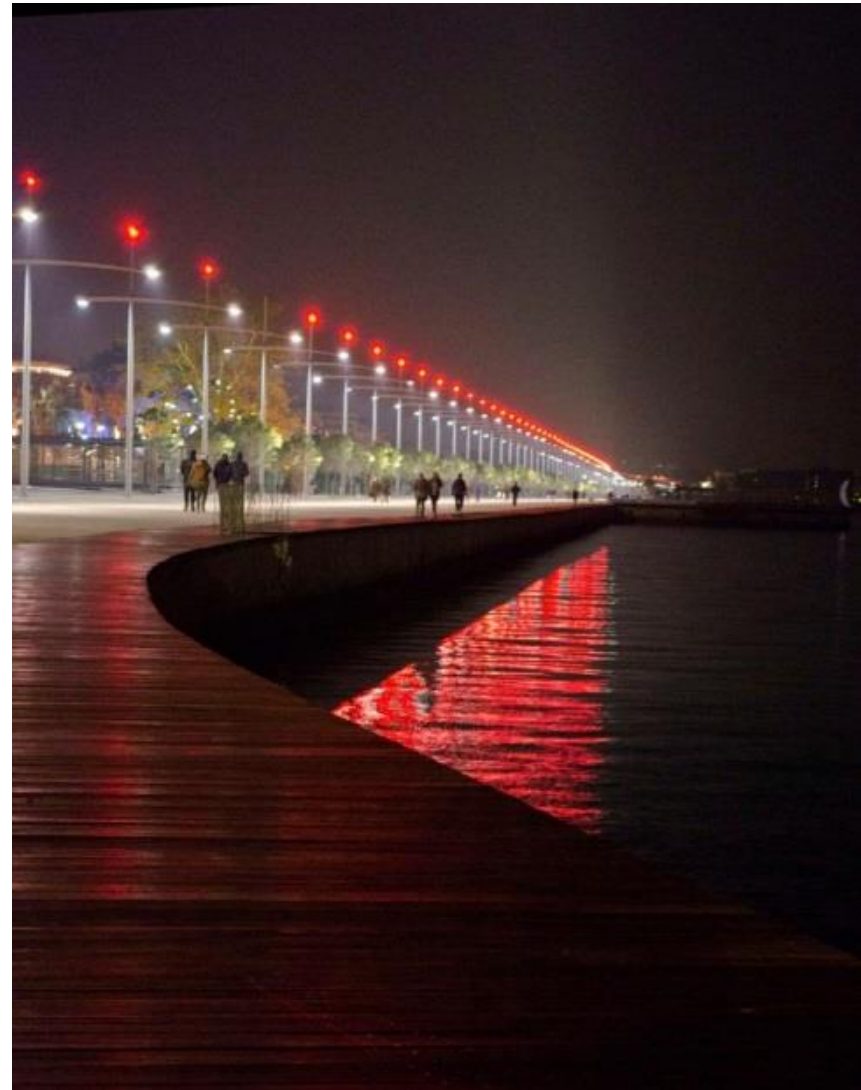

Nikiforidis - Cuomo Architects

INTERNATIONAL UNION OF ARCHITECTS

# Luxembourg

## Belval Train Station

**2014 Highly  
Commended  
Public Building**

**Selected for its  
seamless and  
effortless  
integration of bus  
and train facilities  
with private  
transport. The  
building links by  
footbridge to a  
shopping centre,  
concert hall and  
urban quarter.**





# Luxembourg



**A choice of stairs, elevators and escalators lead passengers safely to their destinations. Particular attention has been paid to the needs of vision impaired people.**

## Belval Train Station

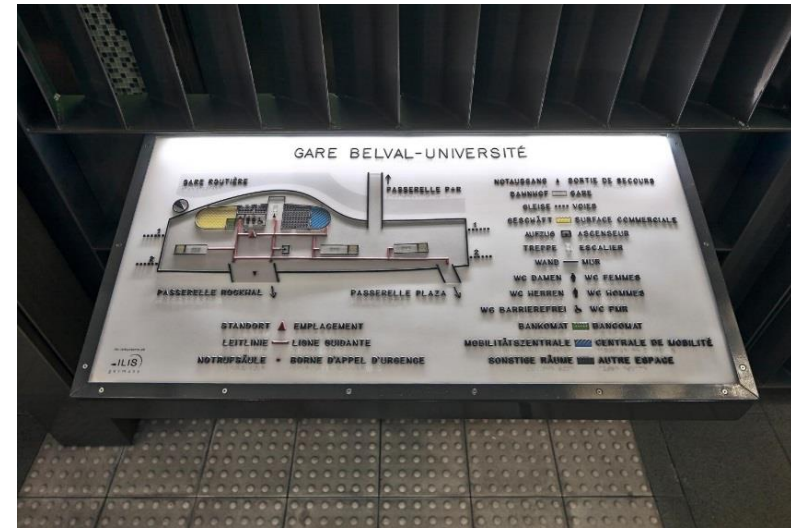



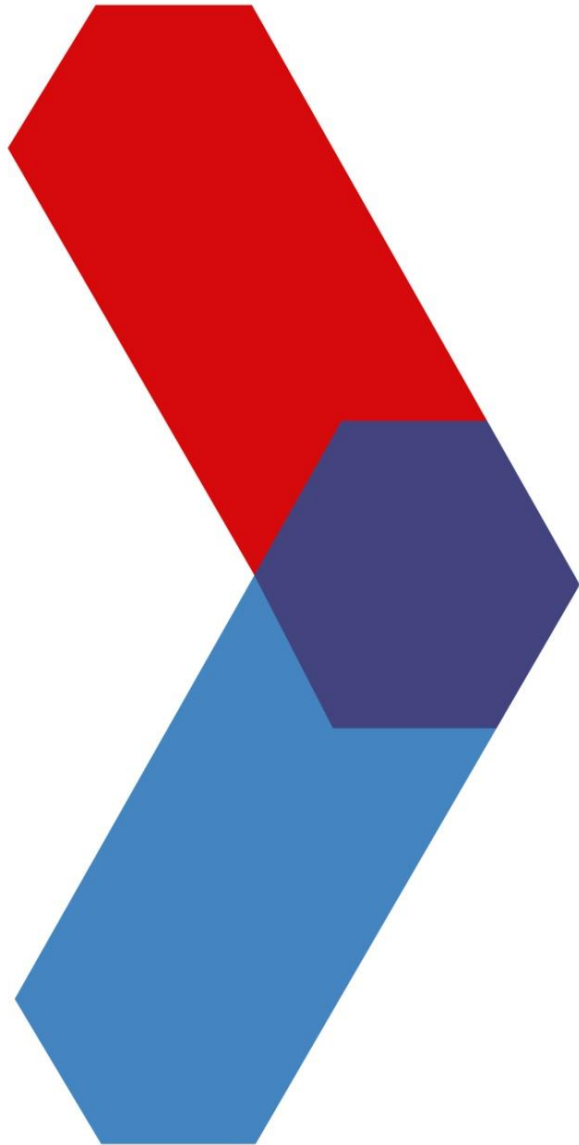

# **UIA Architecture for All Good Practice Database**

# Austria

## St. Margarethen



**The site of an old roman quarry, now used for operas and performances, has been dramatically transformed by the introduction of an access ramp clad in Corten steel**

**Germany**

# WIR wohnen anders, Dortmund



**Intergenerational collective housing**

Post + Welters Architekten & Stadtplaner  
Photo: Cornelia Suhan





Post + Welters Architekten & Stadtplaner  
Photos: Cornelia Suhan

INTERNATIONAL UNION OF ARCHITECTS





**Gently graded  
slopes  
Slip resistant  
steps  
Level thresholds  
and doors both  
wide and high**



**INTERNATIONAL UNION OF ARCHITECTS**

# Denmark

## 8 House



**A complete neighbourhood 10 stories high. Each dwelling, with its own garden or balcony can be accessed by bicycle via a gentle ramp or by stairs or lift**



# Norway

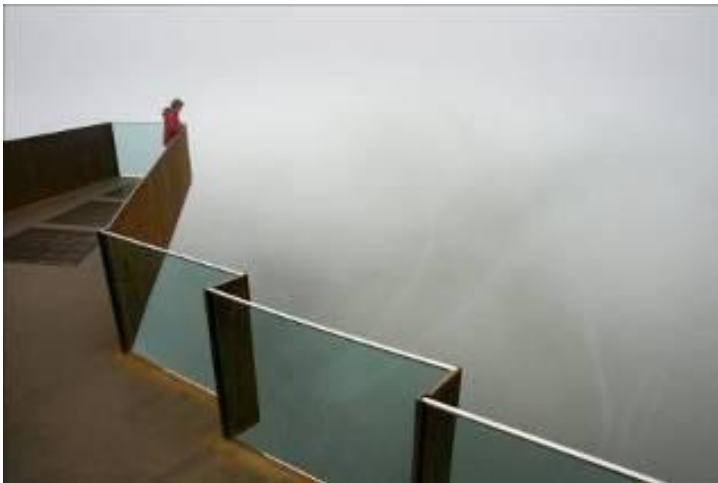

## National Tourist Routes



**“Our job is to make sure  
the routes are adapted  
to travellers’ needs”  
Where everyone can  
experience the beauty &  
the wilderness**

Nasjonale turistveger





**Gudsbrandsjuvet viewing platform**

**Architects: Jensen & Skodvin**



# Norway

# Oslo Opera House



The architect's concept - "easy and open access for all", a public room, a landscape, a focal point for the city and from the sea







**In its first three  
year's more than  
5 million people  
had visited – a  
space for people,  
enjoyed by all**



# Singapore

## Transport Infrastructure



Photo: Joseph Kwan



# Ireland

## Aviva Stadium

The transparency and clear legibility of the unique form contribute to its overall success

The entrance podium was built over a railway station with lifts and escalators to bring people directly to the entry points



Architects: Scott Tallon Walker & Populous

INTERNATIONAL UNION OF ARCHITECTS

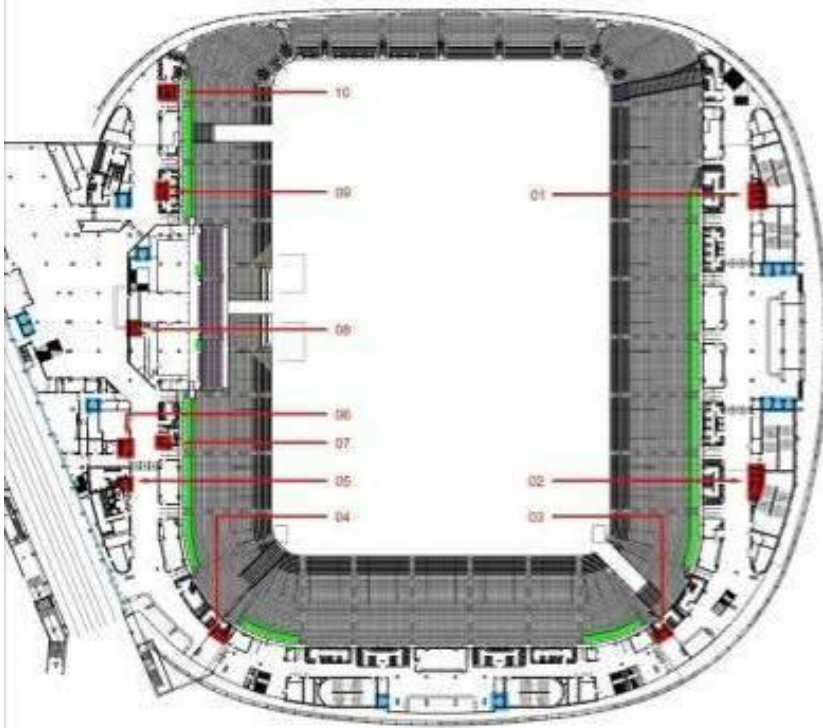

**Consultation with disabled users was ongoing throughout the design process. Drawings were prepared to illustrate the distribution of fully accessible facilities in all areas of the stadium**

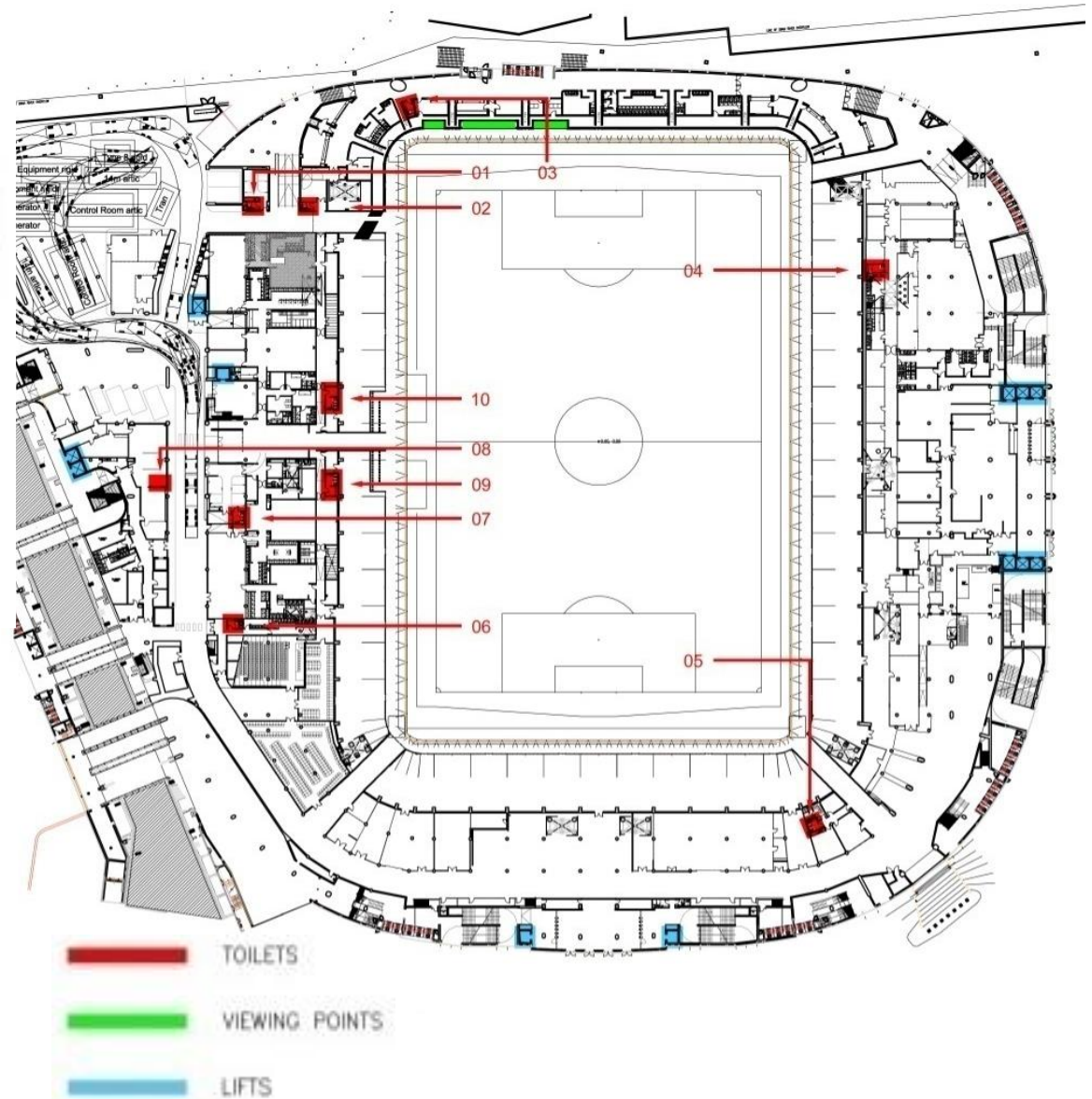



## Tonal contrast

All signage colours have enough tonal contrast with white text to be easily readable.

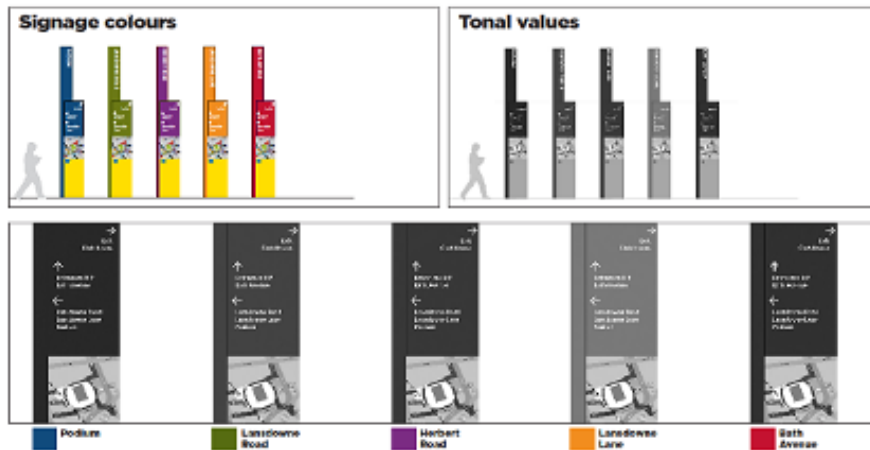

Signage is co-ordinated with maps on match tickets. Colours have been carefully chosen to give adequate tonal contrast



# Viewing Areas

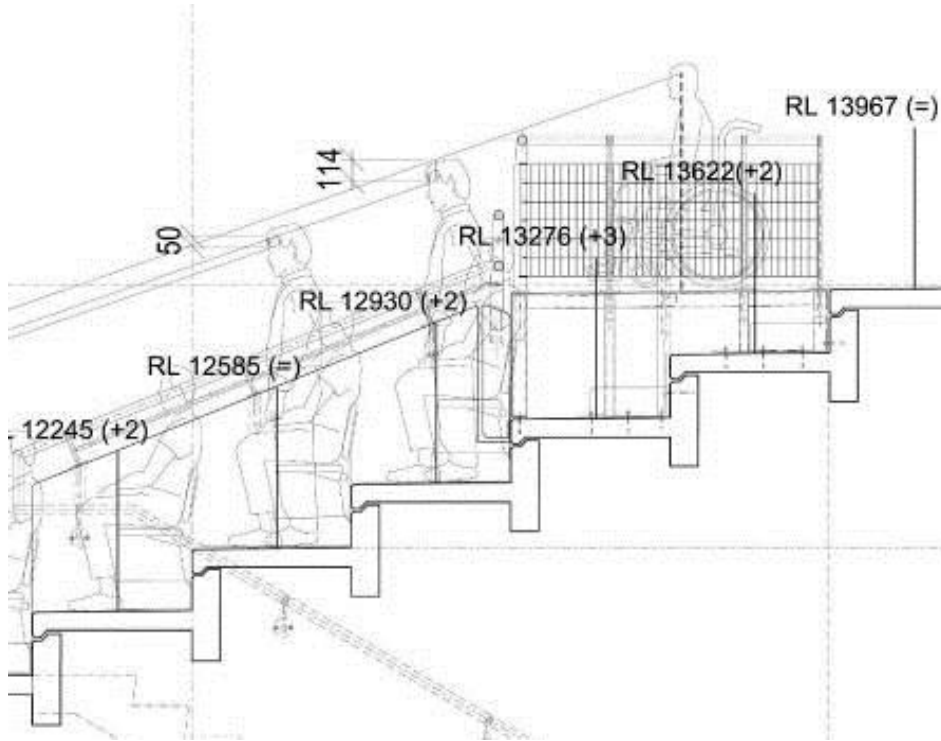

**Wheelchair accessible viewing areas are located on each level and have been carefully considered to ensure good sight lines, with accessible WCs in close proximity**

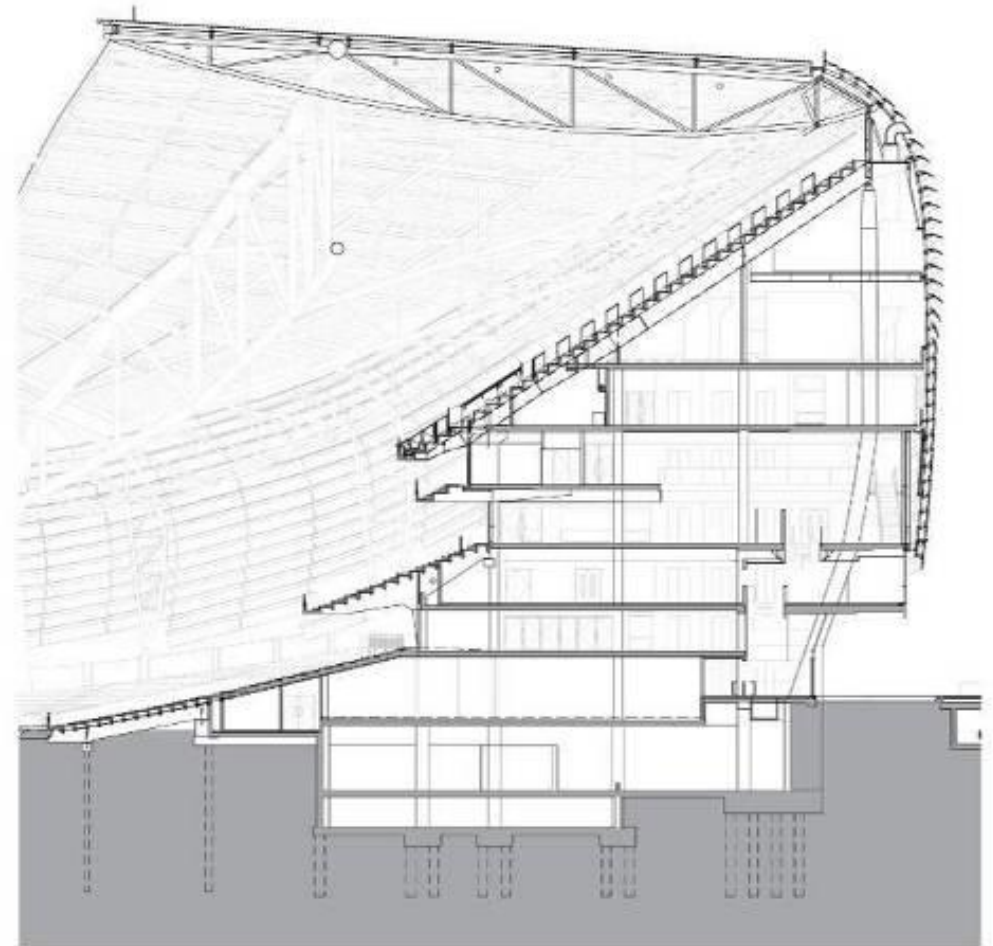



## Internal facilities



Reception areas and bars have been designed to suit all users and induction loops have been installed throughout the building. Fittings have been carefully sited to ensure structural elements do not impede circulation



**Client commitment resulted in an exemplary building which was joint winner of the 2010 ONCE Accessibility Award at the World Architecture Festival**

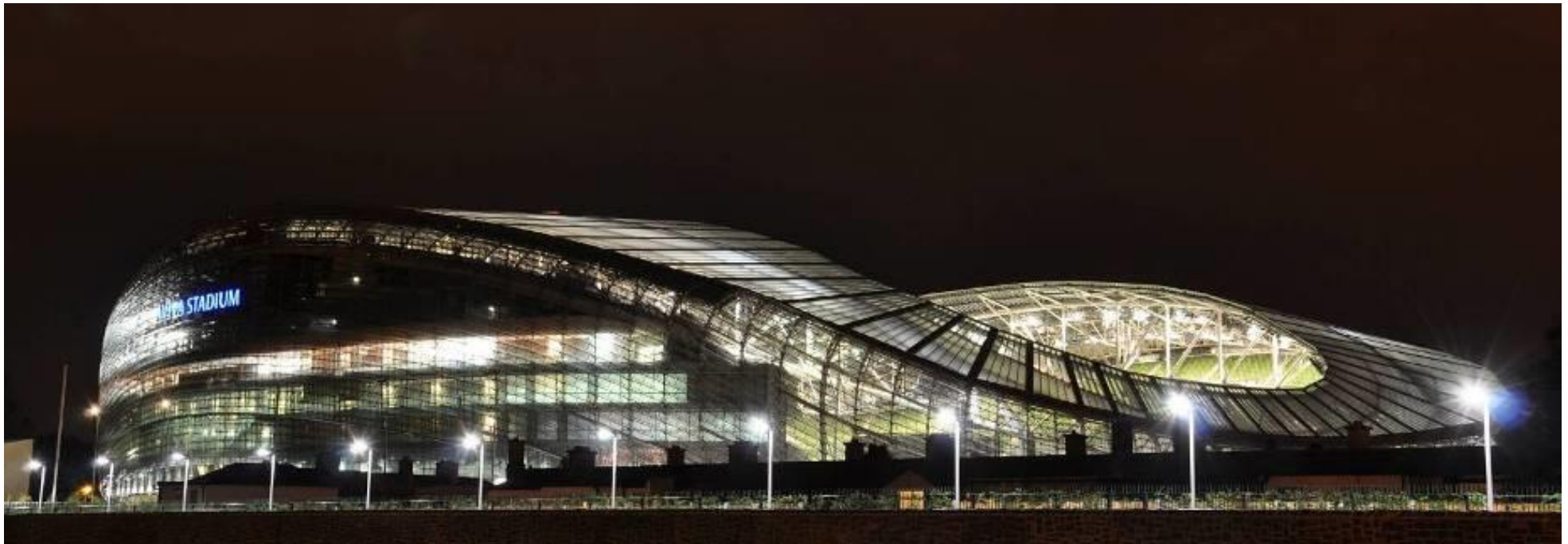



# Denmark

## Office Building



### Key Objectives:

**Spatial Understanding, Clarity, No dead ends, No ramps**



**Key Objectives: Guidance paths, Vertical Connections, Sensory Clues, Easy evacuation**



**INTERNATIONAL UNION OF ARCHITECTS**



# Scotland



Music garden



# Hazelwood School



**The school's sinuous form gently curves around mature trees creating intimate outdoor spaces. An intuitive wayfinding system, with curved tactile wall is used for mobility training**



Architects Gordon Murray + Alan Dunlop

INTERNATIONAL UNION OF ARCHITECTS

# Scotland

## Hazelwood School



**Uncluttered spaces  
with contrasting  
colours and materials –  
the outcome of  
extensive user  
engagement**

Architects Gordon Murray + Alan Dunlop



# Ireland



# 2015 Expo Pavilion

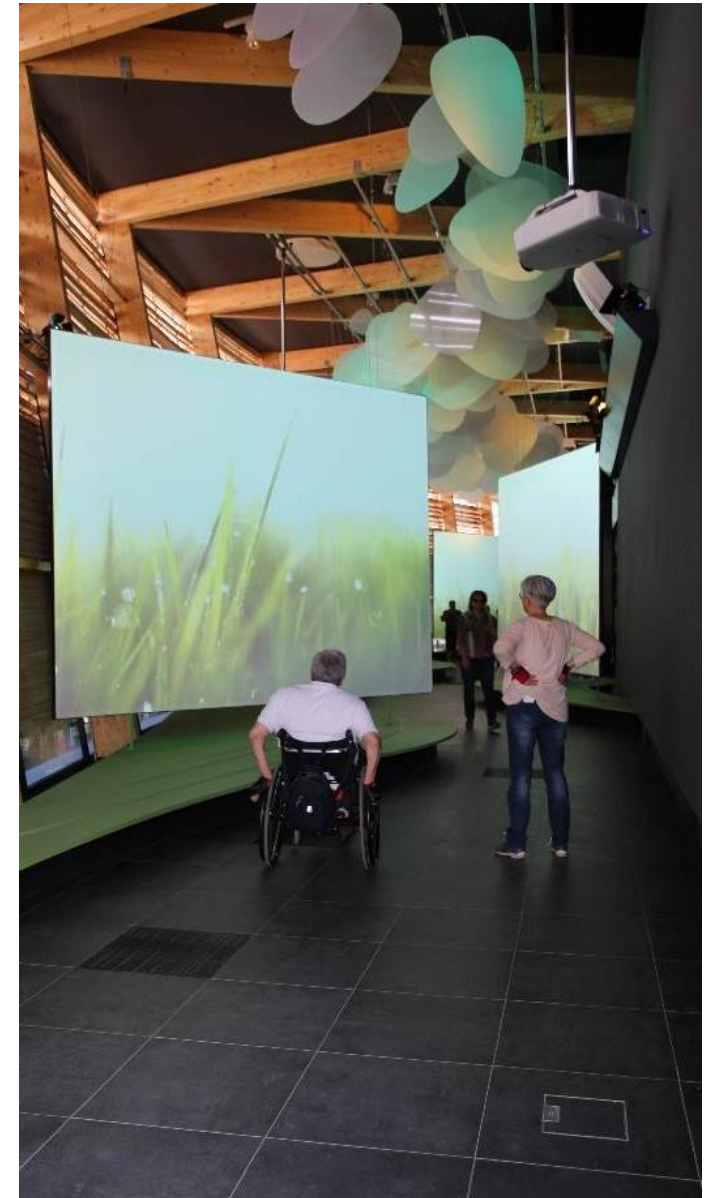

# **Thank you!**

**Fionnuala Rogerson FRIAI**  
**info@rogerson.ie**

Note: All images are copyright and may not be reproduced



**INTERNATIONAL UNION OF ARCHITECTS**